

WHERE TO SHOOT WHAT AT GATEWAY

3/13/2023

DAY MEMBERS and ANNUAL / LIFE MEMBERS: RANGES 1 & 2

RANGE 1, PISTOLS and REVOLVERS: Located to far left as you exit the club store. No rifles or shotguns allowed.

NO FIRING OF HIGH POWER RIFLE ROUNDS (i.e. 223, 556, 7.62x39, 308, etc) ALLOWED ON RANGE 1

RANGE 2, as follows: Located slightly left as you exit the club store. **BENCH SHOOTING ONLY**

RIFLES, CARBINES, AR and AK style pistols with arm brace: All positions except 27 & 28: All calibers including rimfires, pistol calibers, high power/centerfire calibers, and black powder. AR and AK pistols must be fired supported from bench.

SHOTGUNS with shoulder stocks:

Positions 1-26: For shotguns with iron sights or optics, i.e. not a "bead" only front sight and must shoot slugs or turkey loads

Position 27: This position is for "patterning" birdshot loads. Ammunition must be #6 through #9 shot. Position

28: This position is for function checking. Ammunition must be #6 through #9 shot.

SHOTGUNS without shoulder stocks:

Position 28 only: This position is for function checking. Ammunition must be #6 through #9 shot.

ANNUAL AND LIFE MEMBERS ONLY: RANGES 3-8

PISTOLS AND REVOLVERS:

RANGES 5 and 7 including the 25/50 yd Bullseye range: Pistol caliber ammunition only. **NO FIRING OF HIGH POWER RIFLE ROUNDS (i.e. 223, 556, 7.62x39, 308, etc) ALLOWED ON RANGES 5 and 7.**

RANGE 4B: Barrels must be 2 inch minimum length. Pistol caliber ammunition only. **NO FIRING OF HIGH POWER RIFLE ROUNDS (i.e. 223, 556, 7.62x39, 308, etc) ALLOWED ON RANGE 4B.**

RANGE 4A: Barrels must be 10 inch minimum length. **HIGH POWER RIFLE CALIBER ROUNDS ARE NOT ALLOWED.**

RANGE 3: Must be capable of accurate fire at 200 yds. High power rifle caliber rounds ARE allowed.

AR15 AND AK47 STYLE PISTOLS WITH ARM BRACE:

RANGES 2, 4A, and 8: Must be supported/aimed fire from bench. High power rifle caliber rounds ARE allowed on Ranges 2 and 8, **PISTOL CALIBER AND BLACK POWDER ONLY ON 4A.**

HIGH POWER RIFLES:

RANGES 2 and 8: Firing allowed sitting at bench only.

RANGE 3: Firing allowed standing, sitting, prone and sitting at bench.

PISTOL CALIBER AND BLACK POWDER RIFLES AND CARBINES: includes 17 and 22 RF, 38, 44 and 45 but not 223, 556, 7.62x39, 30-30, 308, etc.

RANGES 2, 3, 4A, 4B, 5, 8, and 7 including 25/50 yd Bullseye line.

SHOTGUNS:

RANGE 6: Use clay pigeon targets and birdshot ammunition with #6 through #9 shot. Slugs, buckshot and #4 shot not allowed. **NO RIFLES OR HANDGUNS ALLOWED.**

RANGES 5 and 7: Use with paper targets, clay pigeon targets not allowed.

ARCHERY: RANGES 5 and 7

RANGE MAP

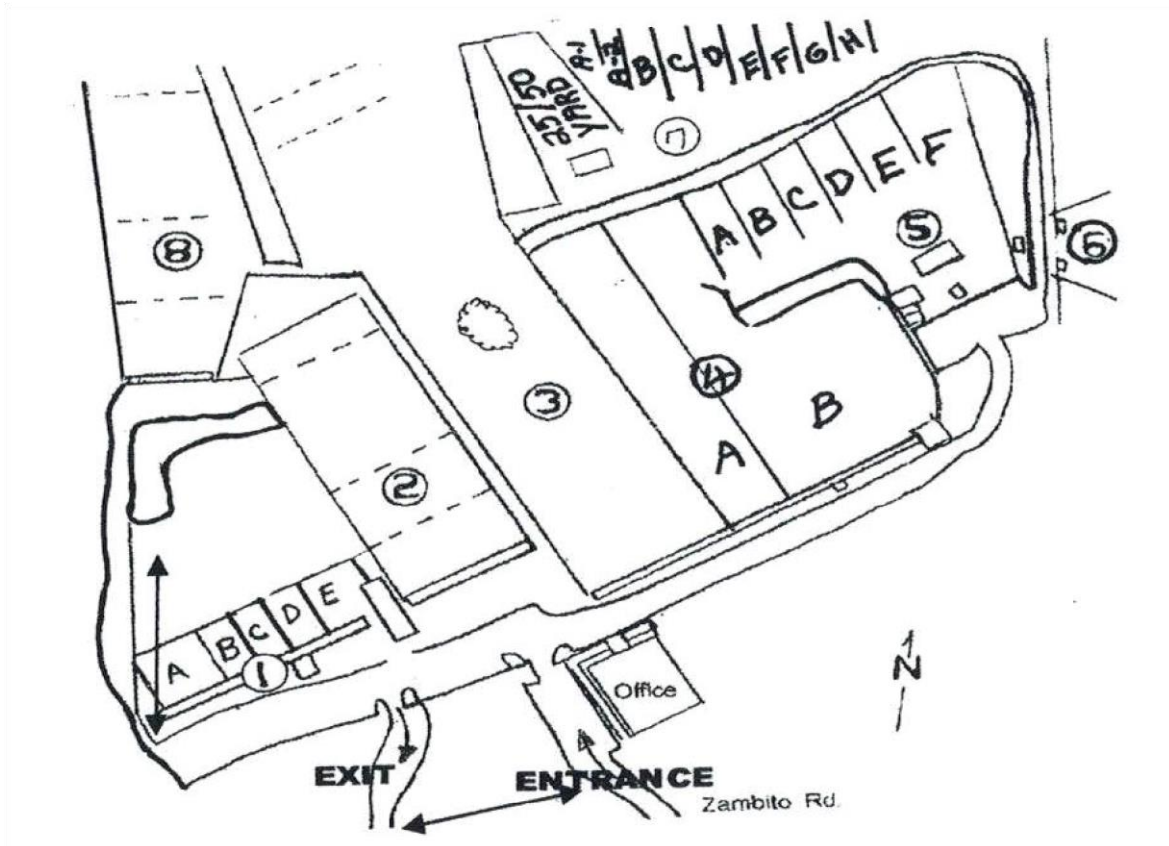

*Range 1: 7 and 15 yard pistol range, **Day members allowed**

Range 2: 100 yard line primarily for rifles, **Day members allowed**

Range 3: 200 yard line primarily for rifles

Range 4A: 100 yard line primarily for rifles, **pistol calibers and black powder only**

Range 4B: Silhouette range, **pistol calibers and black powder only**

Range 5: General purpose bays, **pistol calibers, black powder and shot gun only**

Range 6: Shotgun with birdshot only, **no pistols, black powder or rifles**

Range 7: General purpose bays, **pistol calibers, black powder and shot gun only**

NOTE: FIRING OF "HIGH POWER" RIFLE AMMO LIKE AR/AK .223, 5.56 OR 7.62x39, etc. ON 4B SILHOUETTE RANGE, OR RANGES 5, 6 AND 7 WILL LIKELY RESULT IN LOSS OF MEMBERSHIP