

**2017 DIXIE MATCH**  
**NRA Regional Pistol Championship**  
**.22 Caliber Only Aggregate Match**  
**NRA Distinguished Revolver Match**  
**with CMP Service Pistol EIC Match and CMP .22 RIMFIRE EIC Pistol Match**  
Sponsored by Gateway Rifle and Pistol Club

**Date:** April 21, 22 and 23, 2017

**Location:** Gateway Rifle and Pistol Club, 9301 Zambito Road, Jacksonville, FL 32210

**Eligibility:** Open to any individual. Teams will consist of two (2) or four (4) firing members, plus a coach and a team captain. Refer to NRA Precision Pistol rules for further guidance.

**NRA Membership:** NRA membership is encouraged, but not required to compete. In order to enter scores of competitors in the computer classification system, all competitors who are NRA members must provide their NRA member ID number on their entry form. Non-NRA members who have a classification number must put that number on their entry card.

**Rules:** Current NRA Precision Pistol Rules will govern for the Regional Championship, .22 Caliber Only Aggregate Match and NRA Distinguished Revolver Match. NRA Pistol rules are available on-line at: <http://compete.nra.org/documents/pdf/compete/RuleBooks/Pistol/pistol-book.pdf>. Current Civilian Marksmanship Program rules will govern for the CMP Service Pistol EIC Match and CMP .22 Rimfire EIC Pistol Match. CMP rules are available on-line at: <http://thecmp.org/wp-content/uploads/Rulebook.pdf>. CMP affidavits will be processed during check in.

**Souvenir Award:** A souvenir award will be issued to each competitor.

**Classification:** The NRA classification system will be used in all matches. Individuals who have not been classified will fire in the Master Class. Rule 19.6 (Assigned Classification) may be used.

**Classes:** A minimum of 4 competitors (or 4 teams) will constitute a class. If less than 4 competitors (or 4 teams), those competitors will compete in the next higher class. If there are less than 4 High Masters in a category/class, they will compete for open awards only.

**Categories:** Four or more shooters are required to make a category as defined by NRA rules.

**Divisions:** Open and Metallic Divisions will be recognized. A minimum of 4 competitors will constitute a Division within a class. If there are less than 4 competitors within a Division, those competitors will compete in the next higher Division. (Metallic > Open). Scores within the Divisions for all shooters will count toward NRA Classification.

**.22 Caliber Only Aggregate Match:** Shooters wishing to fire the .22 Caliber Only Aggregate Match will not be eligible for the Regional Champion awards or Dixie Match trophy. See NRA rule 22.

**Challenges & Protests:** A challenge fee of \$3.00 will be charged for each challenge made. See NRA rule 16 for challenge and protest procedure.

## Match Fees:

Entry Fee for Registered 2700	\$85 (Includes NRA fees)
Entry Fee for individual 900	\$30
Entry Fee for Junior (NRA rule 2.3)	\$40
Entry Fee for individual 900 (Junior)	\$15
Late Entry Fee (after April 1)	\$10
Team Matches (.22, CF & 45)	\$15 (per person)
NRA Distinguished Revolver Match	\$5 (if combined with NRA match)
NRA Distinguished Revolver Match	\$10 (if no NRA match included)
CMP Service Pistol EIC Match	\$15
CMP .22 Rimfire Pistol EIC Match	\$15

**Squadding:** All matches will be squadded. Squadding tickets for individual matches will be issued from the Statistical Office and will be available on Thursday, April 20 from 1:00 to 5:30. Competitors must pick up squadding tickets and competitor's packet prior to shooting. NRA classification cards must be exhibited before issue of squadding tickets. A competitor who fails to obtain his squadding tickets or who fails to present himself at the proper firing point when his relay is called may lose his right to compete in that event. Squadding information for the team matches will be posted at the Stat Office or Range Control by noon Friday, April 21.

**Time of Firing:** Firing will commence at 8:00 AM each day. Based on the number of competitors/relays, the Match Director may adjust the starting times of individual and/or team matches.

**Entries:** Entries in individual events will be made by using the enclosed Statistical Office Record Form accompanied by check or money order. Please make checks payable to **Gateway Rifle and Pistol Club**. Be sure to indicate your correct NRA classification, division, category and NRA membership ID number. Confirmation of entry will be e-mailed upon receipt of a paid entry. Confirmation via regular mail will be made only if the competitor encloses a self-addressed, stamped envelope or postcard. Mail the entry form with correct fee to:

Ted Carter  
(Attn: Dixie Championship)  
4412 Hood Road  
Jacksonville, FL 32257

Competitors may scan and return their entry form via e-mail to **cdrcoach@reagan.com**, Subject line: Dixie Match Entry. Note: Payments made after 1 April must include a \$10.00 post entry fee.

NOTE: If you do not get an e-mail response back within several days of sending your registration, you may contact the Match Director at: 904-880-1715.

**Entries Close:** Individual match entries close at 4:00 PM on April 20th. Team match entries close at 11:00 AM of the day the team matches are to be fired.

**Entries Limited:** Entries are limited to 75 competitors. Preference will be given to competitors who fire the full schedule.

**Post Entries:** Entries received after 1 April will be accepted up to the stated limit of the range, provided such entries will not require special relays and must include a \$10 late fee.

**Awards:** The Winner of Regional Championship will receive a Dixie Match trophy plaque and a cash award. NRA Regional Medallions for first, second, and third place open awards in the Regional Championship will be presented. Achievement Pins/Medals for the CMP Service Pistol EIC Match and CMP .22 Rimfire EIC Pistol Match will be provided by the Civilian Marksmanship Program. All other awards are provided by Gateway Rifle and Pistol Club with 50% minimum of Regional fees (less NRA registration fees) being awarded back to the competitors. NRA award points will be given for open and class winners in Matches 1-18 and class winners in Match 19. Second and third place class awards will be given for 8 and 12 competitors in class respectively. Category and Division winners will also receive awards.

**Match Schedule:** For all days, relay start times are as follows:

8:00 AM	Relay 1
10:00 AM	Relay 2
12:00 PM	Relay 3
2:00 PM	Team Matches
After teams	CMP Rimfire Pistol/NRA Distinguished Revolver/CMP Service Pistol

**Friday, April 21, 2017** Match 1 - .22 Caliber Slow Fire  
Match 2 - .22 Caliber National Match Course  
Match 3 - .22 Caliber Timed Fire  
Match 4 - .22 Caliber Rapid Fire  
Match 6 - .22 Caliber Team Match  
CMP .22 Rimfire EIC Pistol Match

**Saturday, April 22, 2017** Match 7 - Center Fire Slow Fire  
Match 8 - Center Fire National Match Course  
Match 9 - Center Fire Timed Fire  
Match 10 - Center Fire Rapid Fire  
Match 12 - Center Fire Team Match  
NRA Distinguished Revolver Match  
CMP Service Pistol EIC Match

**Sunday, April 23, 2017** Match 13 - .45 cal Slow Fire  
Match 14 - .45 cal National Match Course  
Match 15 - .45 cal Timed Fire  
Match 16 - .45 cal Rapid Fire  
Match 18 - .45 cal Team Match  
Service Pistol Team "Fun" Match

Note: Team Matches may be fired in two (2) relays of two (2) team shooters each. The CMP .22 Rimfire EIC Pistol Match will be conducted immediately following the .22 caliber Team Match. The NRA Distinguished Revolver and CMP Service Pistol EIC Match will be conducted immediately following the Center Fire Team Matches. An awards ceremony will be held following completion of the match.

Aggregate Matches:

Match 5 - Regional .22 Caliber Championship, aggregate of Matches 1, 2, 3, and 4

Match 11 - Regional Center Fire Championship, aggregate of Matches 7, 8, 9, and 10

Match 17 - Regional .45 Caliber Championship, aggregate of Matches 13, 14, 15, and 16

Match 19 - Regional Championship, aggregate of Matches 5, 11, and 17

**Practice:** The range will be open to competitors wishing to practice on Thursday, April 20, from 1:00-5:30 PM. Competitors who wish to practice must pick up their competitor packet prior to practice.

**Directions to Range:** From I-295, take 103<sup>rd</sup> Street West 3 miles to Old Middleburg Road (Kangaroo Express/Valero station on right); turn right (North) and proceed 1 mile to No Road Street at stop light; turn left (West), proceeding 1.2 miles to Zambito Road: turn right (North), proceed 0.5 miles to club driveway, on right.

**Lodging:** There are a number of moderately priced motels within 5-10 miles of the range. Note: Gateway Rifle and Pistol Club no longer offers on site RV hook ups. Contact the Match Director for details.

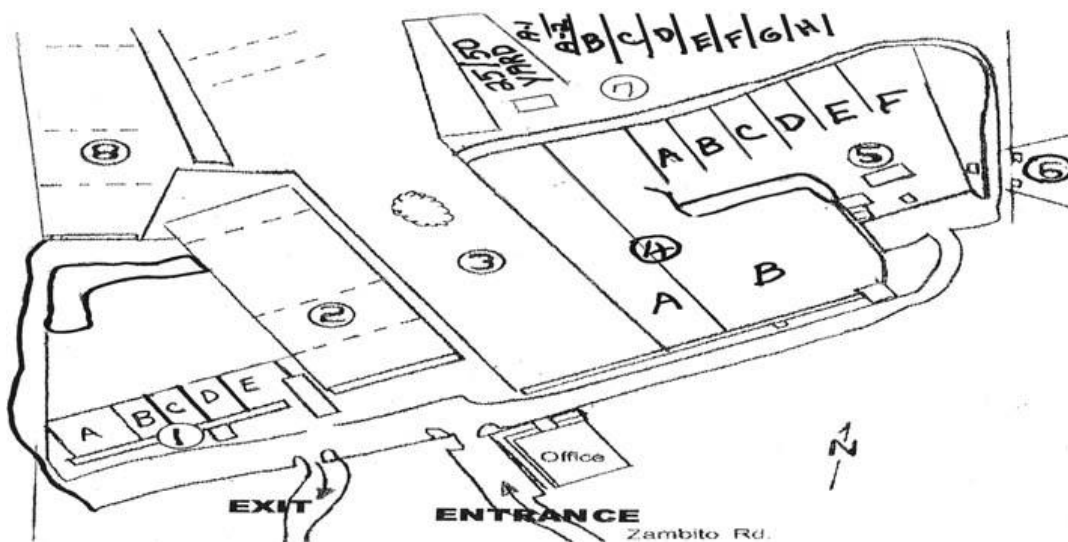

# DIXIE MATCH - STATISTICAL OFFICE RECORD

---

(Please Print)      Last Name                                      First Name                                      Middle Initial

---

Street Address

---

City                                      State                                      Zip Code

---

Best phone number to reach you (Home, Cell, Work)                                      E-mail Address

---

Date of Birth (MM/DD/YYYY)                                      NRA ID #

## **CATEGORIES (circle all that apply) (NRA rule 2. Eligibility and Categories of Competitors)**

Service    Police    Civilian    Veteran    Senior    Grand Senior    Woman    Junior

## **CLASSIFICATION (circle one) (NRA rule 19. National Pistol Classification)**

Unclassified    High Master    Master    Expert    Sharpshooter    Marksman

## **DIVISION (circle one) (NRA rule 3. Equipment and Ammunition)**

.22 Caliber Championship:    Open    Metallic

Center Fire Championship:    Open    Metallic

.45 Caliber Championship:    Open    Metallic

Regional Aggregate Championship:    Determined by the highest Division an individual competes in, in the order listed: Open and Metallic Division(s)

Note: Competitor's classification in the highest Division will be used

## **.22 Caliber Only Aggregate (circle one) (NRA rule 22.)**

Open    Metallic

## **RELAY PREFERENCE (circle one)    First Relay    Second Relay    Third Relay**

Note: Competitors requesting Third relay may be squadded on First or Second relay if there are insufficient competitors to fill a third relay.

# DIXIE MATCH - STATISTICAL OFFICE RECORD

## REGISTRATION FEES

	Before April 1, 2017	After April 1, 2017
2700 Regional Entry:	\$85 _____	\$95 _____
900 State Entry: Circle all that apply (22 CF 45)	\$30 _____	\$40 _____
2700 State Entry: Juniors	\$40 _____	\$50 _____
900 State Entry (Junior): Circle all that apply (22 CF 45)	\$15 _____	\$25 _____
Team Entry:	\$15 _____	\$15 _____
NRA Distinguished Revolver Match	\$5/10 _____	\$5/10 _____
CMP Service Pistol EIC Match:	\$15 _____	\$15 _____
CMP .22 Rimfire EIC Pistol Match:	\$15 _____	\$15 _____
TOTAL:	_____	_____

# DIXIE MATCH

## TEAM MATCH ENTRY FORM

Teams may consist of (2) two or (4) four firing members. Team classification will be determined by the classification of the firing members in accordance with NRA rule 19.12.

In accordance with NRA rule 2.10, entries will not be accepted from “pickup” teams.

In accordance with NRA rule 2.11, all members of club teams, including team captain and coach, must have been fully paid members of the club that the team represents for a period of at least 30 days prior to the competition. The club must be affiliated with the NRA and in good standing.

For award purposes, all teams will compete by NRA classification . Awards by classification will be issued to the winner of the grand aggregate. Four teams are required to form a class.

**Entries will be accepted only with full payment for the entire team.**

TEAM MEMBER	CLASS
1. _____	_____
2. _____	_____
3. _____	_____
4. _____	_____

TEAM CATEGORY (circle one)    Service    Police    Civilian / \_\_\_\_\_

Team Captain: \_\_\_\_\_

Team Name: \_\_\_\_\_

TEAM CLASSIFICATION (circle one)    HM    MA    EX    SS    MK

REGISTRATION FEE \$15    AMOUNT PAID: \_\_\_\_\_