

# The MUZZLEBLAST

One of Florida's Largest Gun Clubs with well over 3,000 members

Volume 2026, Issue 2

May 2026

## Gateway Rifle and Pistol Club hosted the 34th Annual Dixie Match April 11 & 12, 2026

By Sue Carter

On April 11<sup>th</sup> and 12<sup>th</sup>, GRPC held the NRA Regional Dixie Precision Pistol Matches. The Dixie Match combines an NRA Regional Precision Pistol Championship with a .22 Caliber Only Aggregate Match, NRA Distinguished Revolver Match, CMP Service Pistol EIC Match and CMP .22 RIMFIRE EIC Pistol Match. Here are the Grand Aggregate results, as well as the EIC22, the EIC Service Pistol and the Distinguished Revolver (DR) results.

Congratulations to the U.S. Army Marksmanship Unit's (USAMU) Greg Markowski for the win, and to those earning points toward distinguished! Thank you to all the competitors that attended, and all the volunteers! We couldn't do it without you!

### TOURNAMENT RESULTS BULLETIN NRA REGIONAL CHAMPIONSHIP MATCH -- APRIL 11-12, 2026 JACKSONVILLE, FL

#### MATCH NO. 16 -- GRAND AGGREGATE MATCH

##### OPEN -- PLACE AWARDS (37 COMPETITORS)

1	115	Markowski, Greg	2629	129 x	Match Winner
2	117	Gregoire, Jason	2587	107 x	Second Place
3	118	Adams, Ryan	2572	81 x	Third Place

##### SPECIAL CATEGORY AWARDS

115	Markowski, Greg	2629	129 x	High Any Sights
118	Adams, Ryan	2572	81 x	High Metallic Sights
217	Pena, Nestor	2560	86 x	High Senior
110	Grove, Ed	2536	62 x	High Grand Senior
210	Tanner, Sheri	2476	59 x	High Woman
216	Fleming, Wes	2566	87 x	High Civilian
209	Liming, Chris	2525	72 x	High Police
115	Markowski, Greg	2629	129 x	High Service
216	Fleming, Wes	2566	87 x	High Veteran

##### HIGH MASTER -- ALL CATEGORIES (7 COMPETITORS)

1	216	Fleming, Wes	2566	87 x	First High Master - All Categories
2	217	Pena, Nestor	2560	86 x	
3	116	Kopslein, Adam	2522	67 x	
4	114	Erickson, Randy	2481	56 x	
5	205	Radford, James	2055	53 x	

##### MASTER -- ALL CATEGORIES (12 COMPETITORS)

1	215	Innes, Seth	2540	74 x	First Master - All Categories
2	110	Grove, Ed	2536	62 x	Second Master - All Categories
3	122	Fanucci, Robert	2535	73 x	Third Master - All Categories
4	113	Standard, Mate	2521	73 x	
5	111	Turner, Chase	2502	57 x	
6	121	Milen, Michael	2490	69 x	
7	112	Fleming, Lee	2469	54 x	
8	214	Hobart-Fleming, Kimberly	2467	53 x	
9	123	Bertrand, Paul	2422	48 x	
10	119	Hays, Mark	2409	33 x	
11	208	Vogel, Robert	2186	25 x	

##### EXPERT -- ALL CATEGORIES (10 COMPETITORS)

1	209	Liming, Chris	2525	72 x	First Expert - All Categories
2	109	Alleyne, Kelvin	2518	73 x	Second Expert - All Categories
3	213	Goodman, Mark	2457	53 x	
4	105	Ragsdale, Jack	2454	51 x	
5	211	Wells, Russell	2442	52 x	
6	125	Rhiei, Clark	2381	41 x	
7	202	Agneta, Paul	2337	32 x	
8	206	Sharf, Howard	2304	28 x	
9	124	Hathcox, Robert	2298	29 x	
10	212	Fleming, James	2276	22 x	

##### SHARPSHOOTER/MARKSMAN -- ALL CATEGORIES (8 COMPETITORS)

1	210	Tanner, Sheri	2476	59 x	First Sharpshooter/Marksmen - All Categories
2	120	Gillaspie, Louis	2469	41 x	Second Sharpshooter/Marksmen - All Categories
3	104	Rotherforth, Darryl	2349	30 x	
4	203	May, Thomas	2245	25 x	
5	201	Sharf, Brian	1960	25 x	
6	204	Newcomer, Linda	1849	17 x	
7	207	Gill, Russell	1415	14 x	
8	102	Jones, Philip	769	11 x	

##### 22 CALIBER ONLY - ALL CATEGORIES (11 COMPETITORS)

1	106	Young, Jason	2439	37 x	First Place 22 Caliber Only All Categories
2	107	Albrecht, Rand	2384	46 x	Second Place 22 Caliber Only All Categories
3	218	Radford, Kim	2330	23 x	
4	222	Schatzel, Brian	2284	34 x	
5	108	Rhiei, Cheryl	2243	21 x	
6	219	Agneta, Karyn	2108	13 x	
7	221	Goldsmith, Jonah	1796	16 x	
8	220	Hollingshead, John	1641	47 x	
9	223	Hagan, Jack	1493	1 x	
10	224	Hollingshead, Donna	1448	16 x	
11	103	Sordan, Michael	675	2 x	

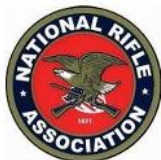

Dixie Match Results continued next page

CMP SERVICE PISTOL MATCH UNOFFICIAL RESULTS

April 12, 2026

PLACE	NAME	DIST	TOTAL	
1	MARKOWSKI	Y	293 14	Gold Achievement
2	GREGOIRE	Y	291 9	Gold Achievement
3	ADAMS	Y	279 3	Gold Achievement
4	STANDARD	Y	277 7	Gold Achievement
5	GILLASPIE	Y	271 5	Silver Achievement
6	INNES	Y	270 6	Silver Achievement
7	ERICKSON	Y	263 2	Bronze Achievement
8	LIMING	Y	260 4	Bronze Achievement
9	HAYS	Y	259 2	Bronze Achievement
10	GOODMAN		257 6	Bronze Leg / Bronze Achievement
11	RADFORD, J	Y	255 2	Bronze Achievement
12	AGNETA, P		254 2	Bronze Achievement
13	FLEMING, J		245 5	
14	JONES		236 3	
15	BERTRAND	Y	225 2	
16	WELLS		219 2	
17	RHIEL, CLARK		216 3	
18	GARRETT		178 1	
19	HAGAN		147 3	

Total	
Dist	11
ND Military	1
ND Civilian	7

DISTINGUISHED REVOLVER PREPORTING FORM

Tournament Sponsor: Please list, IN DESCENDING ORDER BY SCORE, all competitors firing in your NRA Distinguished Revolver Match. Point winners will be determined at NRA Headquarters after verification of Distinguished and Non-Distinguished competitors. (Use additional pages if necessary)

LOCATION: Jacksonville, FL

DATE OF DISTINGUISHED MATCH: April 12, 2026

DISTD	NAME	SLOW	TF	RF	SCORE
1	Y GREGOIRE	89 2	96 3	98 4	283 9
2	Y ERICKSON	85 2	98 3	96 2	279 7
3	Y MARKOWSKI	87 1	94 2	94 1	275 4
4	ADAMS	85 0	93 2	92 1	270 3
5	LIMING	85 2	86 0	84 0	255 2
6	FANUCCI	75 0	89 2	87 1	251 3
7	MAY	86 0	84 0	74 1	244 1
8	ROTHERFORTH	71 0	82 1	85 2	238 3
9	HOBART-FLEMING	86 1	76 0	74 1	236 2
10	HAYS	79 0	78 1	74 0	231 1
11	GOODMAN	56 0	90 0	83 1	229 1
12	HAGAN	53 0	73 1	72 0	198 1

## Have you heard of the Concealed Pistol Home Defense Shotgun Match

By Willy Whiskers

On the 3<sup>rd</sup> Sunday of every month, on range 5, a group of shooters gather to toss lead down range in light competition. We call it the Concealed Pistol Home Defense Shotgun Match or just Home Defense for short. It is a pistol-shotgun match, but shooters have the option to include a pistol caliber carbine (PCC) to make it a 3 gun competition.

Back in 2017 a group of cowboys out of Fort White hit on the idea of shooting modern guns but using the cowboy's steel targets. They called it EDC, Everyday Carry. Our local cowboys, Cowford Regulators, liked the idea and they brought the match to GRPC. The rules

and regulations did not fully transfer to Gateway, so some modification took place, including a name change to Concealed Pistol Home Defense Shotgun Match or CPHDSM. You may have seen this abbreviation on the range calendar and not given it a thought.

We shoot virtually everything from .22 to .45 and have categories to accommodate whatever guns you bring. There are two caveats. 1. Because the cowboy targets are used, no jacketed ammo is allowed. We shoot lead, Federal Syntech or powder coated lead. It used to be harder to find lead 9mm, but North Florida Ammo in Orange Park has all the ammo we shoot. Of course, some shooters load their own. 2. Because we often move with the shotgun, no semi-auto shotguns are used. Break action or pumps work well for us. We use bird shot (#4 to #9) in any shotgun bore.

Semi-Auto with Pump (SP) and Semi-Auto with Pump & carbine (SPC) are the most popular categories.

However, many shoot revolvers (double action only). We even have categories where the shooter can use a pistol not only for pistol targets but also in place of the carbine. You might want to shoot Josey Wales, 4 revolvers and a break shotgun.

We invite you to come out and give us a look, 3<sup>rd</sup> Sunday at 8:00 AM. For more details and information contact: Willy Whiskers, willywhiskers45@gmail.com. 904-477-1066.

## Reloading

By Gary Kight

Whether you're an experienced reloader or just getting started, you'll quickly discover that there are many types of presses on the market—and just as many opinions about which one is “best.” This article isn't meant to dive into every detail of how presses operate, but rather to provide a general overview of what's available and what

---

many of us consider when choosing reloading equipment.

If you're a beginner, start by asking yourself what you plan to reload—pistol, rifle, or shotgun—and how much you expect to produce each week. For simplicity, this discussion focuses on commonly used, consumer-level presses. High-end commercial equipment and shotgun reloading can be saved for another time.

Whether you favor Lee, Hornady, RCBS, Dillon, or another brand, the truth is that they all make quality presses. Choosing the “best” one often comes down to personal preference and what feels right to you.

Reloading requires more than just a press. You'll use dies, components, cleaning tools, reference materials, and some form of record keeping. Just like presses, dies come in different brands, and it's perfectly acceptable to use brand “A” dies in brand “B” presses. Dies shape the case or seat the bullet, and they're made for specific cartridges in either steel or carbide, depending on whether the case is bottlenecked or straight-walled.

Reloading presses themselves come in several configurations, but the two most common types are single-stage and progressive presses. A single-stage press performs one operation with each pull of the handle, making it slower but easier for beginners to learn each step. A progressive press performs several operations at once, greatly increasing production speed, but requiring more attention since multiple things happen simultaneously.

I learned on a single-stage RCBS Rock Chucker that I inherited from my uncle, and I'm grateful for that experience because it taught me the feel of each step in the process. Later, I added a Dillon XL650 progressive press for higher-volume work, but I still use the Rock Chucker for precision tasks—and now I own two of them.

This has been a brief overview of reloading presses and some of the components involved. There are many steps in the reloading process, and I can't emphasize enough the importance of research. Read books, watch instructional videos, talk to experienced reloaders, and—if you can—observe someone reloading in person. The more you learn, the better and safer your results will be.

If you would like to contribute an article about reloading or anything gun related to the Muzzleblast feel free to reach out to me, Gary Kight at 904-509-8130.

## **Police Work Can be Stressful and Dangerous**

by Glen Outlaw

Everyone knows that police work can be very stressful and dangerous. We never know what we are “walking into” on any type of call: robbery in progress, domestic, traffic stop, suspicious person, etc.

One such call took place in the summer of 1977. I had been with the JSO for just about 2 years. I was on the midnight shift as I recall. Long before malls took off, all the major stores were in downtown Jacksonville: Penney's, Sears, Woolworth, etc. About 0200 or so on the Sunday, a unit was dispatched to West Bay St. to the Sears store. Upon arrival, the officer stated, over the radio, a large window was broken out.

Several more units, including me, headed that way. Not knowing if there were any suspects inside, a few officers, including me, entered the store to search while several others surrounded the building. Of course, all the lights were off except a few scattered around the first floor of this business. We all had our weapons drawn and carried our flashlights. Every one of us was very cautious but all were also very nervous. We had all been inside for what seemed like a “century,” but it was actually about 10 minutes...LOL. Suddenly, everyone

heard 2 shots ring out! Everyone, including me, ran to the sound of the shots. Upon arrival, there was a brother Officer, weapon still in hand, and a "suspect" on the floor with 2 perfect shots into the K-5 area!! Job well done we all thought ??!?! until we all looked a little closer at the "suspect"...a mannequin! In the heat of the moment, this brother Officer came around a corner and suddenly observed a "suspect lunging out towards him". He reacted as trained and fired his weapon in self-defense. As I mentioned above, this was in the middle of summertime. This mannequin was part of a display for summer and was placed in an upright position with arms raised as if jumping. In the heat of the moment, this brother, in his mind, observed what we thought was a suspect jumping to attack him which is why he fired in self-defense. Thankfully, all Officers were unharmed, but the "suspect" needed some "plastic surgery"! We understand that this mannequin later was able to return to work but was now asking for additional "Hazardous Duty Pay"!



## Disciplines

At GRPC, we have an extensive range of disciplines which enable the sportsman to broaden their core skills or to extend them into new positions. They include Junior Shooters, Blackpowder, Smallbore silhouette, High power rifle, Cowboy, Rimfire BR and Bullseye pistol. Check one or more of these disciplines out sometime.

- Cowboy
- High Power Rifle
- Smallbore Rifle Silhouette (Standard, Hunting & Cowboy)
- Rimfire Benchrest
- Conventional Outdoor Pistol (Bullseye)
- Muzzleloader (Rifle & Pistol)
- Junior Shooters
- Concealed Pistol/Home Defense Shotgun Match



## ATTENTION



UNTIL FURTHER NOTICE, VARIOUS RANGES WILL BE CLOSED FOR LEAD MINING ON A DAILY BASIS. WE DO NOT ALWAYS KNOW WHEN THE CLOSINGS WILL BE DONE DUE TO POSSIBLE INCLEMENT WEATHER CONDITIONS.

AS OF NOW, THE SCHEDULE IS FOR RANGES 2, 3, AND 4A TO UNDERGO LEAD MINING ON MAY 4<sup>TH</sup>, 2026.

PLEASE CALL THE MAIN OFFICE AT 904-771-2937 EXT. 5 FOR DAILY UPDATES.

---

# Where To Shoot What at Gateway

By Randy Erickson

## DAY MEMBERS and ANNUAL / LIFE MEMBERS: RANGES 1 & 2

**RANGE 1, PISTOLS and REVOLVERS:** Located to far left as you exit the club store.

**No rifles or shotguns allowed**

**NO FIRING OF HIGH POWER RIFLE ROUNDS (i.e. 223, 556, 7.62x39, 308, etc.) ALLOWED ON RANGE 1**

**RANGE 2, as follows:** Located slightly left as you exit the club store.

### **BENCH SHOOTING ONLY**

**RIFLES, CARBINES, AR and AK style pistols with arm brace:** All positions except 27 & 28: All calibers including rimfires, pistol calibers, high power/centerfire calibers, and black powder. AR and AK pistols must be fired supported from bench.

### **SHOTGUNS with shoulder stocks:**

Positions 1-26: For shotguns with iron sights or optics, i.e. not a "bead" only front sight and must shoot slugs or turkey loads  
Position 27: This position is for "patterning" birdshot loads. Ammunition must be #6 through #9 shot.

Position 28: This position is for function checking. Ammunition must be #6 through #9 shot.

### **SHOTGUNS without shoulder stocks:**

Position 28 only: This position is for function checking. Ammunition must be #6 through #9 shot.

## ANNUAL AND LIFE MEMBERS ONLY: RANGES 3-8

### **PISTOLS AND REVOLVERS:**

RANGES 5 and 7 including the 25/50-yard Bullseye range: Pistol caliber ammunition only.

**NO FIRING OF HIGH POWER RIFLE ROUNDS (i.e. 223, 556, 7.62x39, 308, etc.) ALLOWED ON RANGES 5 and 7.**

RANGE 4B: Barrels must be 2-inch minimum length. Pistol caliber ammunition only.

**NO FIRING OF HIGH POWER RIFLE ROUNDS (i.e. 223, 556, 7.62x39, 308, etc.) ALLOWED ON RANGE 4B.**

RANGE 4A: Barrels must be 10-inch minimum length.  
**HIGH POWER RIFLE CALIBER ROUNDS ARE NOT ALLOWED.**

RANGE 3: Must be capable of accurate fire at 200-yards.  
**High power rifle caliber rounds ARE allowed.**

### **AR15 AND AK47 STYLE PISTOLS WITH ARM BRACE:**

RANGES 2, 4A, and 8: Must be supported/aimed fire from bench. High power rifle caliber rounds ARE allowed on Ranges 2 and 8,  
**PISTOL CALIBER AND BLACK POWDER ONLY ON 4A.**

### **HIGH POWER RIFLES:**

RANGES 2 and 8: Firing allowed sitting at bench only.

RANGE 3: Firing allowed standing, sitting, prone and sitting at bench.

### **PISTOL CALIBER AND BLACK POWDER RIFLES AND CARBINES:**

includes .17 and .22 Rimfire, .38, .44 and .45 but not .223, .556, 7.62x39, 30-30, 308, etc.  
RANGES 2, 3, 4A, 4B, 5, 8, and 7 including 25/50-yard Bullseye line.

### **SHOTGUNS:**

RANGE 6: Use clay pigeon targets and birdshot ammunition with #6 through #9 shot. Slugs, buckshot and #4 shot not allowed. **NO RIFLES OR HANDGUNS ALLOWED.**

RANGES 5 and 7: Use with paper targets, clay pigeon targets not allowed.

### **ARCHERY: RANGES 5 and 7**

See the next page for a range map and details on the different ranges

## RANGE MAP

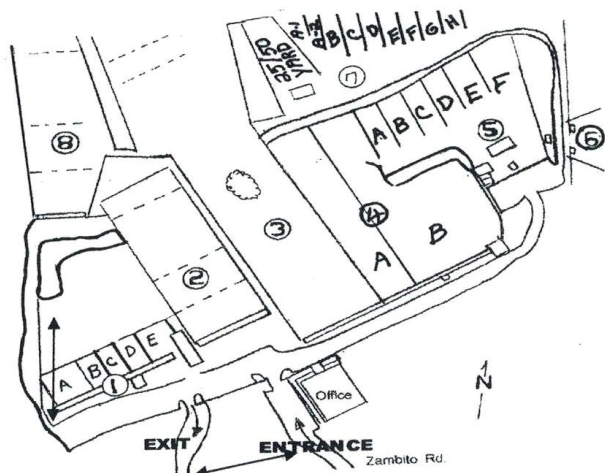

### Range Details:

**Range 1:** 7- and 15-yard pistol range, **Day members allowed**

**Range 2:** 100-yard line primarily for rifles, **Day members allowed**

**Range 3:** 200-yard line primarily for rifles

**Range 4A:** 100-yard line primarily for rifles, **pistol calibers and black powder only**

**Range 4B:** Silhouette range, **pistol calibers and black powder only**

**Range 5:** General purpose bays, **pistol calibers, black powder and shotgun only**

**Range 6:** Shotgun with birdshot only, **no pistols, black powder or rifles**

**Range 7:** General purpose bays, **pistol calibers, black powder and shot gun only**

**NOTE: FIRING OF "HIGH POWER" RIFLE AMMO LIKE AR/AK .223, 5.56 OR 7.62x39, etc. ON THE 4B SILHOUETTE RANGE, OR RANGES 5, 6 AND 7 WILL LIKELY RESULT IN LOSS OF MEMBERSHIP**

# CLUB INFORMATION

## Gateway Rifle & Pistol Club

9301 Zambito Ave. N  
Jacksonville, FL 32210

904.771.2937

www.GRPC-JAX.com

## Where to Shoot

### Day Members or Annual and Life Members

Ranges 1 A-B-C-D: Pistols only with pistol calibers. Location: Far left (West) as you leave front office, 53 positions at 7/15 yards

Range 2: Rifles at 25-50 and 100 yards and shotguns on select positions

### Annual and Life Members Only

Both of above two ranges, #1 and #2

Range 3: Rifle 50- and 200-yards and Pistols with 10 inch Barrels or longer chambered for rifle cartridges

Range 4A: Same as Range 3 except 100-yards only

Range 4B: Rifles in rim fire .22 cal, .17 cal plus black powder rifles

Range 5 A-B-C-D-E-F: All-purpose ranges for Pistols and Rifles with Pistol Calibers

Range 6: Shotgun Skeet Range with only #6 to #9 Shot

Range 7 A-B-C-D-E-F-G-H: All Purpose ranges for Pistols and Rifles with Pistol Calibers, 25-/50-Yard Pistol Match Range, Pistols and Rifles with Pistol Calibers

Range 8: Rifle, 25-, 50- and 100-yard Rifle targets

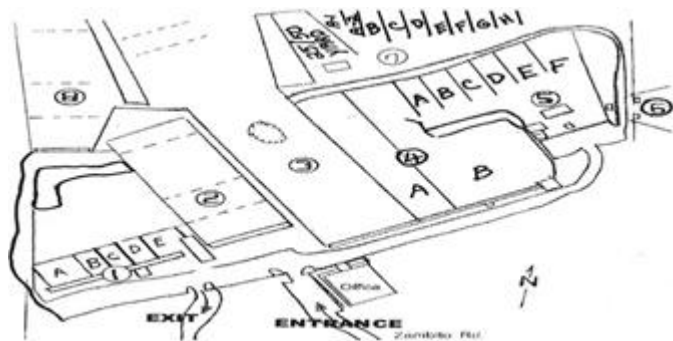

### ID BADGES

#### All Shooters:

Annual, Life, and Day Members must wear ID badges at all times when on the Club property.

### 2026 Slate of Officers

Officer	Name	Contact Info
President	Bill Edwards	pres@grpc-jax.com
Vice President	Bill King	
Secretary	Randy Erickson	
Treasurer	Susan Carter	

### 2026 Board Members

Tim Allen	Doug Havens
Carl Berg	Gary Kight
Walt Gallahan	Alan Rosner
Don Hardeman	William Todorsky
Tim Hardy	
<b>Emeritus Directors:</b>	
Bill Craig	
Sam Grimes	
Allen Way	

### Range Maintenance Schedule

Day	Time	Range
Monday	0800-1100	100-yard Rifle Range
Tuesday	0800-1100	All Pistol Ranges
Wednesday	0800-1100	Silhouette Range
Thursday	0800-1100	200-yard Rifle Range
Friday	0800-1100	All Multi-Purpose Ranges and New 100-yard Rifle Range

*Note: Subject to change based on maintenance need*

### Gateway Rifle & Pistol Club, Inc.

A private Club operated since 1965, providing a safe environment for the sport of shooting. We offer annual memberships allowing unlimited use of the shooting ranges and daily memberships for the occasional shooter limited to certain ranges. The Club is open 7 days a week from 8:00 am until near dusk except Easter, Thanksgiving, and Christmas. There are numerous pistol ranges at various distances for shooting paper targets and steel plates. The rifle ranges provide 25, 50, 100, and 200 yard shooting positions. For those interested in competition there are monthly matches for small bore, black powder, .22 50/50 Benchrest, bullseye pistol, 3x20 prone, NMC and Cowboy, etc.

There is an active junior program and women's program. The facilities include the rifle and pistol shooting positions, a large club house, meeting rooms, and a store selling those items you may need at the range including targets, ammunition, and eye and ear protection. There is a Range Safety Officer on duty at all times.

<b>Tournament Schedule:</b>			
<b>Match</b>	<b>Range</b>	<b>Day</b>	<b>Time</b>
ARA Rimfire	4B	3 <sup>rd</sup> Friday	Call range
Smallbore F-class	4A	1 <sup>st</sup> Saturday	0800-1100
22 Rimfire Benchrest	4B	1 <sup>st</sup> Saturday	1000-1400
Club 1800 Pistol	7	1 <sup>st</sup> Sunday	0900-1200
High Power Rifle Prone	3	2 <sup>nd</sup> Saturday	0800-1100
Black Powder	4	2 <sup>nd</sup> Saturday	0800-1100
High Power Rifle XTC	3	2 <sup>nd</sup> Sunday	0800-1100
NRA 1800 Bullseye	7	3 <sup>rd</sup> Sunday	0900-1200
Concealed Pistol/Home Defense Shotgun Match	5	3 <sup>rd</sup> Sunday	0900-
Smallbore Silhouette	4	4 <sup>th</sup> Saturday	0800-1400
Cowboy	5	4 <sup>th</sup> Saturday	0900-

Note: The above schedule is periodically subject to change: please check the website

#### Disclaimer

The Muzzleblast is published periodically by Lori Hallauer under the direction of the Gateway Rifle & Pistol Club. All newsletter content to be approved by the GRPC prior to publication. Technical and/or handloading data are for informational purposes only. No responsibility is accepted for results obtained by persons using such data, and all liability for any consequential injuries or damages is disclaimed. References herein to any specific commercial product, process or service by trade name, trademark, manufacturer or otherwise, does not necessarily constitute or imply endorsement, recommendation or favoring by The Gateway Rifle & Pistol Club, Inc., its Board of Directors, its membership, the editor, nor the Publisher. Letters to the editor should be brief, to the point, of firearm-related interest and contain the signature, address and telephone number of the sender. Letters to the editor do not necessarily reflect the views of the editor, publisher or Gateway Rifle & Pistol Club. Send submissions to: Gateway Rifle & Pistol Club, 9301 Zambito Rd., Jacksonville, FL 32210 or to the Muzzleblast editor at: [redhawks1980@hotmail.com](mailto:redhawks1980@hotmail.com).

Thank you for reading! If you would like to submit information, articles, or match scores, please send them to:

Gary Kight at [gdk1969@yahoo.com](mailto:gdk1969@yahoo.com) or  
Lori Hallauer at [redhawks1980@hotmail.com](mailto:redhawks1980@hotmail.com)

<b>Disciplines/Contacts:</b>
<b>IR 50/50 22 Benchrest</b> Russ Ost RussOst@bellsouth.net
<b>Smallbore Rifle Silhouette</b> Grit Preston      Adam Smith 904.545.9435      904.801.6451
<b>Single Action Shooting Society (SASS)</b> Vivian Allen-Parido vivianallenmd@aol.com
<b>High Power Rifle</b> Marion Estes marionestes4952@gmail.com
<b>3x20 High Power Rifle</b> Grit Preston 904.545.9435
<b>Black Powder Muzzle Loading</b> Stan Goldy 904.859.8887
<b>NRA/1800 Bullseye/2700 Bullseye</b> Ted Carter 904.880.1715 or cdrcoach@reagan.com
<b>Pellet Silhouette</b> Mike Hicks 904.304.2265
<b>Cowboy Action</b> Vivian Allen-Parido vivianallenmd@aol.com
<b>Junior Shooters</b> Marion Estes marionestes4952@gmail.com
<b>Smallbore F Class</b> Emil Albertini 904.759.8672 or ejalbertini@comcast.net
<b>Women's Programs</b> Sue Carter 904.880.1715
<b>Concealed Pistol/Home Defense Shotgun</b> Willy Todorsky Willywhiskers@yahoo.com
<b>Black Gun Owners and Education (BGOE)</b> Jeffrey Howell 813.304.9774
<b>ARA Rimfire</b> Robert Atkinson, Mike Roy, or John O'Brien gatewayrimfire@gmail.com